

Plan Information

Tenure Type	Freehold
Plan Type	Deposited Plan
Plan Purpose	Subdivision

Plan Heading

Lots 2312-2325, Covenant and Restrictive Covenant

Locality & Local Government

Locality	Dayton
Local Government	City of Swan

Department of Planning, Lands and Heritage

File Number	
-------------	--

Examination

Examined	Date
----------	------

Planning Approval

Planning Authority	Western Australian Planning Commission
Reference	158367

Delegated under S. 16 P&D Act 2005	Date
------------------------------------	------

In Order For Dealings

Subject To	
------------	--

For Inspector of Plans and Surveys	Date
------------------------------------	------

Plan Approved Reg. 26A (4)

Inspector of Plans and Surveys / Authorised Land Officer	Date
--	------

Survey Details

Field Records	118628, 132378
Declared as Special Survey Area	Yes

Survey Method Regulatory Statement

Survey carried out under Reg. 26A Special Survey Area Guidelines. See survey sheet(s) to determine the true final position and type of all survey marks placed for this plan.

Survey Method and Plan Content Variations

Approved Variation Type	Reference
-------------------------	-----------

Survey Certificate - Regulation 54

I, Matthew B. WEBB hereby certify that this plan is accurate and is a correct representation of the -

(a) survey; and

(b) calculations from measurements recorded in the field records, undertaken for the purposes of this plan and that it complies with the relevant written law(s) in relation to which it is lodged.

FINAL

Licensed Surveyor	Date
-------------------	------

Survey Organisation

Name	MNG MCMULLEN NOLAN GROUP
Address	PO Box 124, BULLCREEK W.A. 6149
Phone	6436 1599
Fax	6436 1500
Email	info@mngsurvey.com.au
Reference	93980dp-629c

Amendments

Version	Lodgement Type	Amendment Description	Authorised By	Date
---------	----------------	-----------------------	---------------	------

Former Tenure

New Lot / Land	Parent Plan Number	Parent Lot Number	Title Reference	Subject Land Description
2312-2325	DP 4 19083	Lot 9056	2985/125	

New Notifications and Memorials

Subject	Purpose	Statutory Reference	Origin	Land Burdened	Benefit To	Comments
⊗ ⊙	RESTRICTIVE COVENANT	SEC 136D OF THE TLA 1893	THIS PLAN & DOC	LOTS 2312-2325	LOTS 2312-2325	
	COVENANT	SEC 150 OF THE P & D ACT 2005	THIS PLAN	LOT 2312	COMMISSIONER OF MAIN ROADS	RESTRICTION OF ACCESS No vehicular access is permitted to/from Reid Highway
	NOTIFICATION (Factors Affecting Use or Enjoyment of Land)	SEC 70A OF THE TLA 1893	DOC	LOTS 2312-2325		TRANSPORT NOISE



MCMULLEN NOLAN GROUP
PO Box 124, Bullcreek W.A. 6149
Tel: (08) 6436 1599
Fax: (08) 6436 1500
Email: info@mngsurvey.com.au

MNG Ref : 93980dp-629c - Stage 1T3 - DP428574.CSD

ADDITIONAL SHEETS
SURVEY SHEETSHEET SHEETS
1 OF 2VERSION NUMBER
1DEPOSITED PLAN
428574

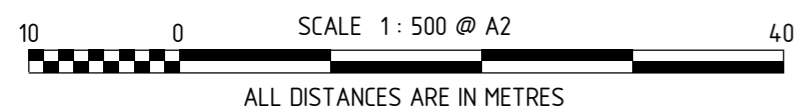
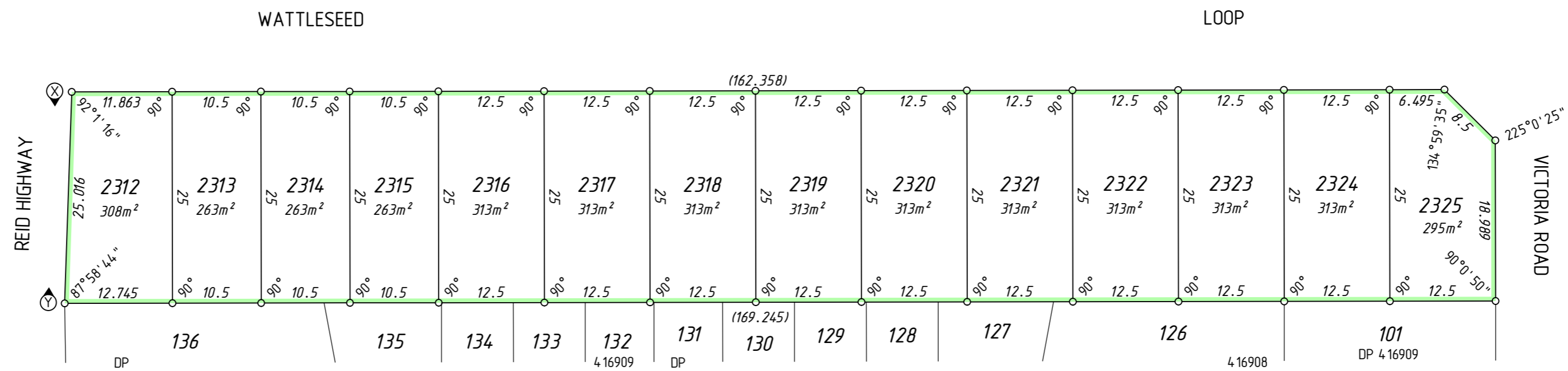

MC MULLEN NOLAN GROUP
 PO Box 124, Buntine WA 6149
 TEL: (08) 6436 1500
 FAX: (08) 6436 1500
 Email: info@mngsurvey.com.au

MNG Ref : 93980dp-629c - Stage 113 - DP428574.CSD

ADDITIONAL SHEETS
 SURVEY SHEET

SHEET SHEETS
 2 OF 2

VERSION NUMBER
 1

DEPOSITED PLAN
428574

THIS SURVEY SHEET WILL BE
REPLACED BY THE SURVEY DATA



MC MULLEN NOLAN GROUP
PO Box 124, Bunkers Creek W.A. 6149
Tel: (08) 6436 1500
Fax: (08) 6436 1500
Email: info@mngsurvey.com.au

MNG Ref : 93980dp-629c

VERSION NUMBER

1

DEPOSITED PLAN

428574