

**Plan Information**

Tenure Type	Freehold
Plan Type	Deposited Plan
Plan Purpose	Subdivision

**Plan Heading**

Lots 2618-2631, Roads, Road Widening and Restrictive Covenant

**Locality & Local Government**

Locality	Dayton
Local Government	City of Swan

**Department of Planning, Lands and Heritage**

File Number

**Examination**

Examined \_\_\_\_\_ Date \_\_\_\_\_

**Planning Approval**

Planning Authority	Western Australian Planning Commission
Reference	162288

Delegated under S. 16 P&amp;D Act 2005 \_\_\_\_\_ Date \_\_\_\_\_

**In Order For Dealings**

Subject To \_\_\_\_\_

For Inspector of Plans and Surveys \_\_\_\_\_ Date \_\_\_\_\_

**Plan Approved** Reg. 26A (4)

Inspector of Plans and Surveys / Authorised Land Officer \_\_\_\_\_ Date \_\_\_\_\_

**Survey Details**

Field Records	131532, 154696
Declared as Special Survey Area	Yes

**Survey Method Regulatory Statement**

Survey carried out under Reg. 26A Special Survey Area Guidelines. See survey sheet(s) to determine the true final position and type of all survey marks placed for this plan.

**Survey Method and Plan Content Variations**

Approved Variation Type	Reference

**Survey Certificate - Regulation 54**

I, Matthew B. WEBB  
 hereby certify that this plan is accurate and is a correct representation of the -  
 (a) survey; and  
 (b) calculations from measurements recorded in the field records,  
 undertaken for the purposes of this plan and that it complies with the relevant  
 written law(s) in relation to which it is lodged.

**FINAL**

Licensed Surveyor \_\_\_\_\_ Date \_\_\_\_\_

**Survey Organisation**

Name	MNG MCMULLEN NOLAN GROUP
Address	PO Box 3526, SUCCESS W.A. 6964
Phone	6436 1599
Fax	6436 1500
Email	info@mngsurvey.com.au
Reference	93980dp-599b

**Amendments**

Version	Lodgement Type	Amendment Description	Authorised By	Date

**Former Tenure**

New Lot / Land	Parent Plan Number	Parent Lot Number	Title Reference	Subject Land Description
2618-2631	DP 421703	Pt LOT 9000	4023-917	

**New Notifications and Memorials**

Subject	Purpose	Statutory Reference	Origin	Land Burdened	Benefit To	Comments
	RESTRICTIVE COVENANT	SEC 136D OF THE TLA 1893	THIS PLAN & DOC	LOTS 2618-2631	LOTS 2618-2631	

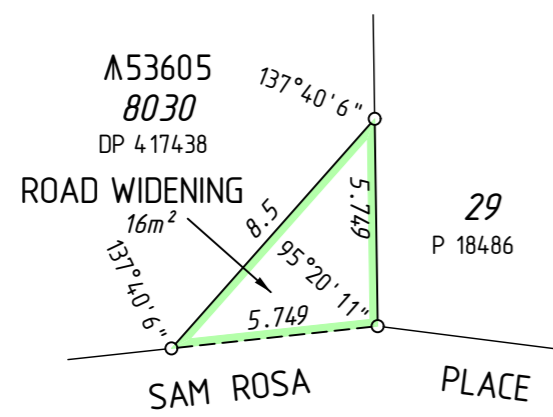
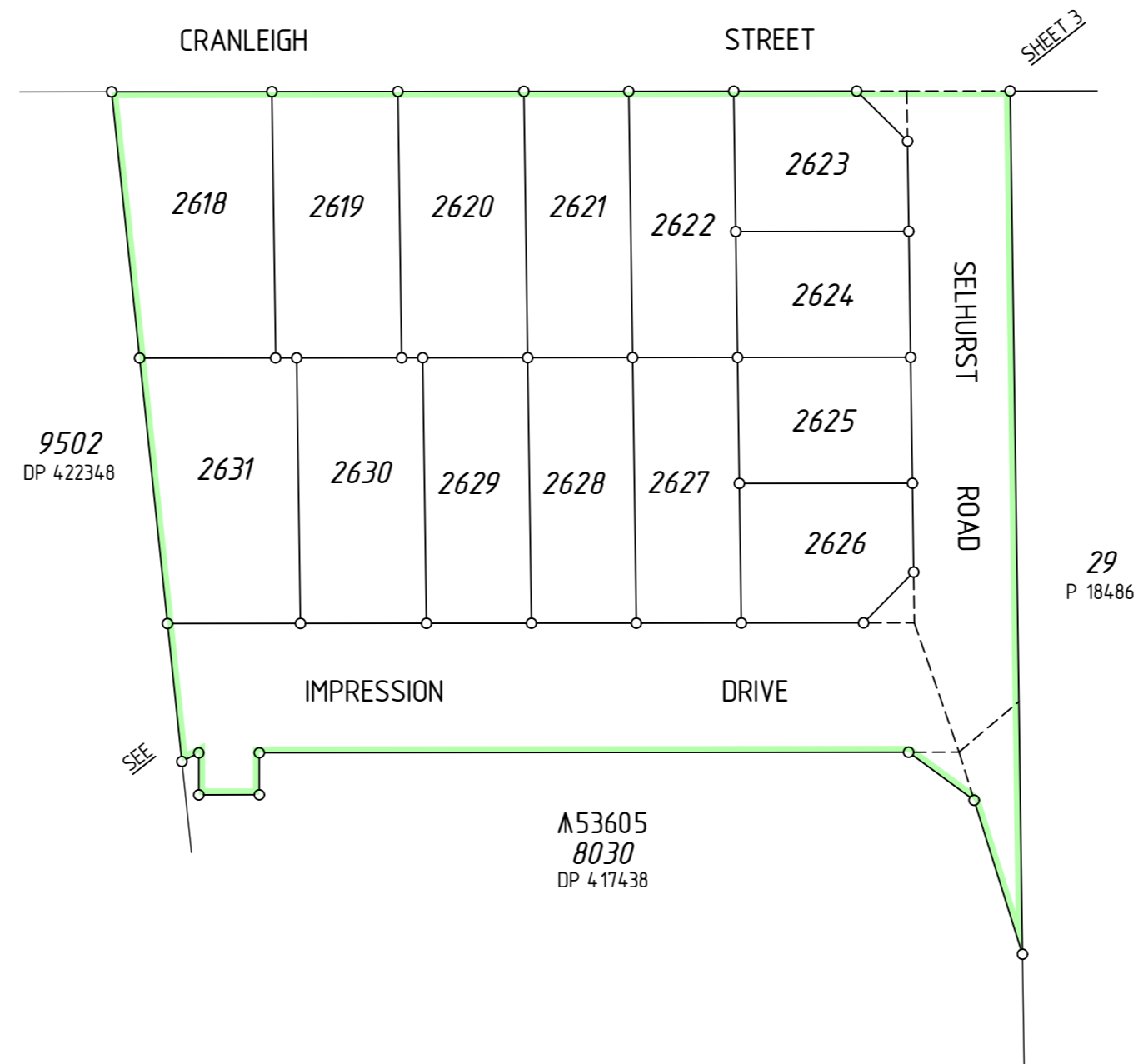

ENLARGEMENT 'B1'  
Not to Scale

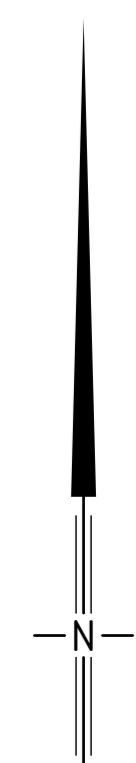
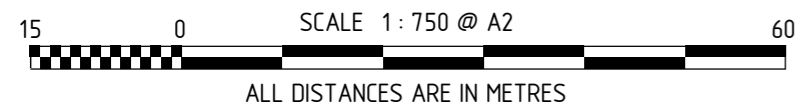
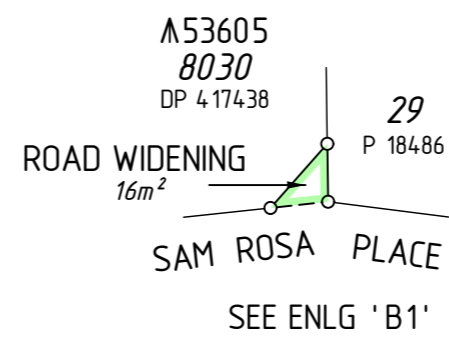

MC MULLEN NOLAN GROUP  
PO Box 3526, Success W.A. 6964  
Tel: (08) 6436 1500  
Fax: (08) 6436 1500  
Email: info@mngsurvey.com.au

MNG Ref : 93980dp-599b - Stage 1U - DP416778.CSD

ADDITIONAL SHEETS  
SURVEY SHEET

SHEET SHEETS  
2 OF 3

VERSION NUMBER  
1

DEPOSITED PLAN  
416778

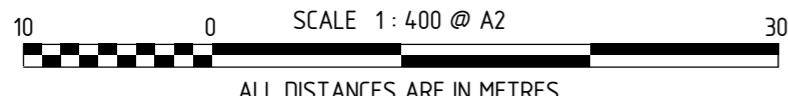
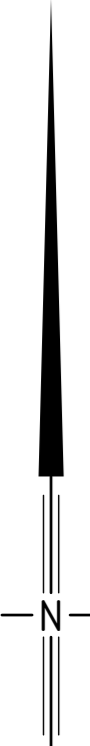

THIS SURVEY SHEET WILL BE  
REPLACED BY THE SURVEY DATA



MC MULLEN NOLAN GROUP  
PO Box 3326, Success W.A. 6964  
Tel: (08) 6436 1599  
Fax: (08) 6436 1500  
Email: info@mngsurvey.com.au

MNG Ref : 93980dp-599b

VERSION NUMBER

1

DEPOSITED PLAN

416778