

NOTES

- THE DRAWINGS SHALL BE READ IN CONJUNCTION WITH THE CONTRACT DRAWINGS AND SPECIFICATIONS.
- THE CONSTRUCTION OF WORKS SHALL COMPLY WITH THE WATER CORPORATION'S DESIGN STANDARD 'DSS0'.
- ALL PIPE SIZES IN MILLIMETRES (DIA 150 U.O.S.). ALL DISTANCES AND LEVELS IN METRES.
- DISTANCES GIVEN ARE AT THE INTERSECTION OF SEWERS.
- THE CONTRACTOR SHALL ENSURE THAT ALL LOTS ARE SERVED WITH HOUSE CONNECTIONS. (DUPLIX LOTS TO HAVE TWO CONNECTIONS).
- EARTHWORKS TO BE COMPLETED PRIOR TO CONSTRUCTION OF SEWER.
- LOCAL AUTHORITY - CITY OF SWAN
- ACCESS CHAMBER DEPTHS ARE SHOWN FOR WATER CORPORATION INFORMATION ONLY.
- BASE INFORMATION
 - LEVELS ARE REDUCED FROM AUSTRALIAN HEIGHT DATUM.
 - ESTIMATED G.W.L: 19.3m
- CENTRELINES OF ACCESS CHAMBERS, SEWER PIPES AND END OF I.O. LINES ARE TO BE ON ALIGNMENTS OF 3.1m IN ROAD RESERVES, 2.0m IN LANEWAYS AND 1.0m INSIDE LOTS UNLESS OTHERWISE SHOWN.
- FOR OPEN TRENCH EXCAVATION:
 DN100 PIPES TO BE PVC CLASS SN6 TO AS/NZS 1260.
 DN150 TO DN375 PIPES TO BE PVC CLASS SN8 FOR DEPTHS UP TO 7.0m AND PVC CLASS SN16 WHEN DEPTH IS BETWEEN 7.0m & 9.5m, BOTH IN ACCORDANCE WITH AS/NZS 1260.
 FOR TRENCHLESS TECHNIQUES DN150 SEWER PIPES TO BE PVC CLASS 9 TO AS/NZS 1477 OR CLASS SN16 TO AS/NZS 1260, DN225 SEWER PIPES TO BE CLASS SN16 TO AS/NZS 1260, DN300 & DN375 SEWER PIPES TO BE CLASS 12 TO AS/NZS 1477.
 - SEWER PIPES UP TO & INCLUDING DN300 TO BE SOLVENT CEMENT JOINTED. DN375 SEWER PIPES TO BE RUBBER RING JOINTED.
- ALL HOUSE CONNECTIONS DEEPER THAN 1.5m ARE TO BE BROUGHT UP TO WITHIN 1.0m OF THE SURFACE.
- INSPECTION SHAFTS AT THE END OF I.S. SEWERS ARE REQUIRED TO BE BROUGHT UP TO WITHIN 0.6m OF THE SURFACE WHERE THE LAST UPSTREAM PIT IS A MAINTENANCE SHAFT.
- MINIMUM COVER OF SEWERS TO BE 1.0m IN ROAD CROSSINGS AND 0.75m IN LOTS AND ROAD VERGE. CONTRACTOR TO REPORT ANY DISCREPANCIES TO THE SUPERINTENDENT.
- ACCESS CHAMBERS LESS THAN 6.0m DEEP SHALL BE PRECAST CONCRETE OR STANDARD BRICK CONSTRUCTION UNLESS NOTED OTHERWISE.
- ALL CONNECTIONS TO LIVE SEWERS TO BE BY WATER CORPORATION AT CONTRACTORS EXPENSE.
- CONTRACTOR TO ENSURE RE-INSTATEMENT OF ALL EXISTING SERVICES AND FENCES UPON COMPLETION OF WORKS.
- WHERE A SEWER LINE INTERSECTS WITH A STORMWATER DRAINAGE LINE AND THE SEWER PASSES OVER THE DRAIN THEN THE SEWER SHALL HAVE A TIMBER PILE AND KEEL PROVIDED FOR THE FULL EXTENT NECESSARY TO SUPPORT THE SEWER DURING EXCAVATION FOR THE DRAIN.
- ALL LEVELS SHALL BE LOCATED FROM ESTABLISHED BENCHMARKS AS SUPPLIED BY THE PROJECT SURVEYOR.
- THE CONTRACTOR SHALL LIAISE WITH THE PROJECT SURVEYOR AND SHALL ENSURE ALL AS-CONSTRUCTED DETAILS ARE RECORDED PRIOR TO ANY WORKS BEING BACKFILLED.

LEGEND

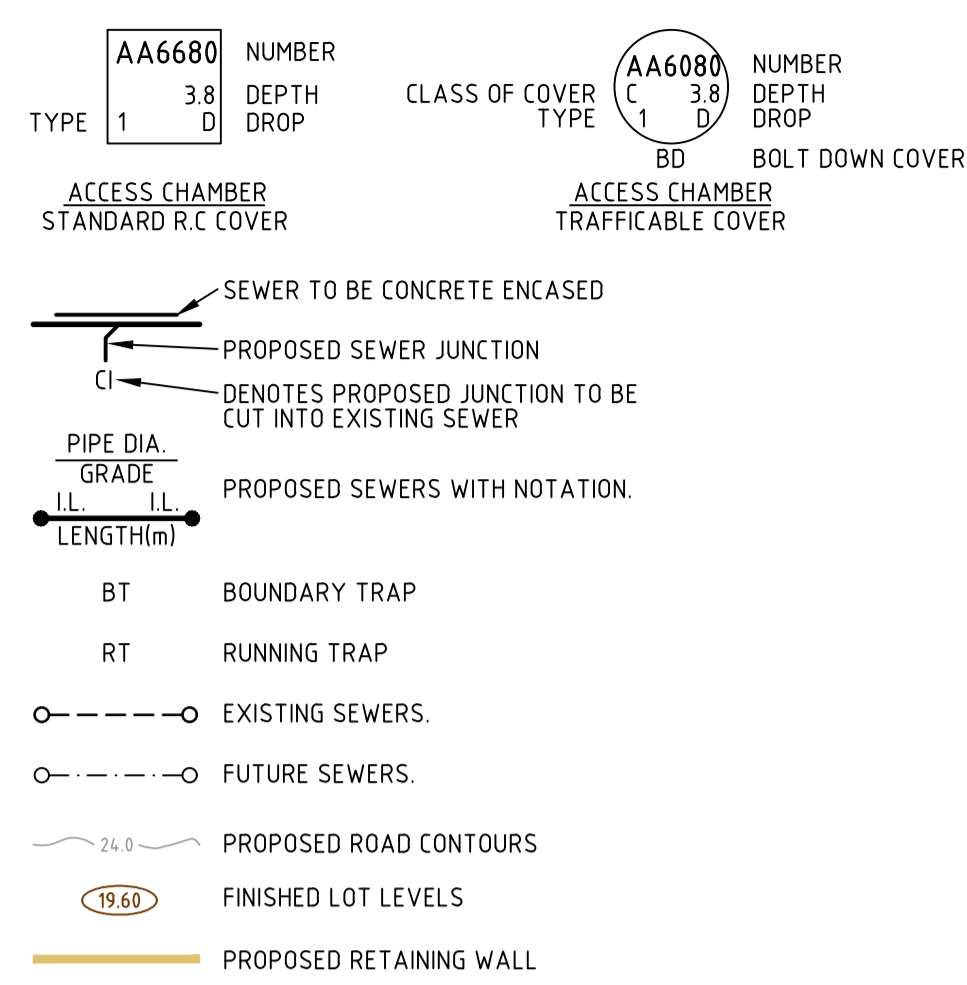

LOCALITY

- LOCAL AUTHORITY - CITY OF SWAN
- LENGTH OF SEWERS : Ø150 - 429.1m
- NO. OF ACCESS CHAMBERS: 1
NO. OF MAINTENANCE SHAFTS: 4
- ESTIMATED GROUND WATER LEVEL - 19.3m
- NUMBER OF LOTS SERVED: 30

DESIGN DATA

- NETT AREA TO BE SERVED (Stage 1Y) - 1.02 ha
- TOTAL PEAK FLOW - 0.38 l/s

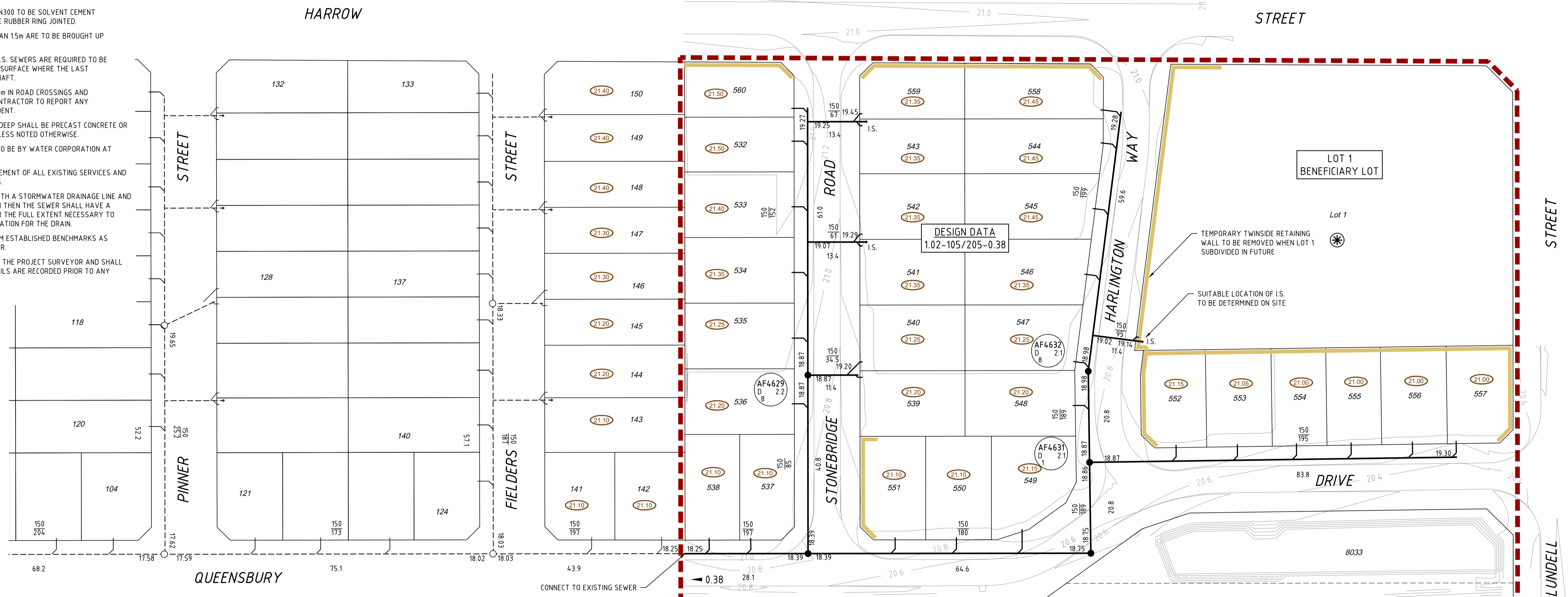

This plan is accepted as complying with overall Scheme Planning. Compliance with relevant manuals remains the responsibility of the Consulting Engineer. No works are to commence on site until startup arrangements have been made with the relevant Works Inspector. See Developer's Manual for contact details.

for Manager LAND SERVICING

NR13-203-001-01B

FILE No.: 116100128 RETICULATION AREA: EDEN HILL
 WAPC No. 160391



No.	DATE	DRAWN	APPROVED	AMENDMENT	No.	DATE	DRAWN	APPROVED	AMENDMENT
0	29.06.21	RDE	JZ	ISSUED FOR CONSTRUCTION.					
C	24.06.21	RDE	JZ	BENEFICIARY LOT ADDED.					
B	09.06.21	RDE	JZ	ISSUED FOR APPROVAL.					
A	20.05.21	RDE	JZ	ISSUED FOR COMMENTS & PRICING.					

This plan shall not to be used for construction unless issued as rev O and signed as approved.

COPYRIGHT
 The concepts and information contained in this document are the Copyright of TABEC Pty. Ltd. Use or copying of the document in whole or part without the written permission of TABEC Pty. Ltd. constitutes an infringement of copyright.

CLIENT	PROGRESS DEVELOPMENTS ST LEONARDS		
DESIGNED	RDE	CHECKED	JZ
APPROVED	B. FARRELL		
DATE	29.06.21		
DRAWN	RDE	CHECKED	JZ

TABEC
 Civil Engineering Consultants

14 Wickham Street, East Perth WA 6004
 1 08 9425 5900 info@tabec.com.au www.tabec.com.au

PROJECT	ST LEONARDS ESTATE, DAYTON - STAGE 1Y		
TITLE	SEWER RETICULATION AND DESIGN DATA PLAN		
DRAWING NUMBER	2223-1Y-201		ISSUE
			0

T:\Projects\2223\Design\CAD\Drawings\Stage 1Y\2223-1Y-201.dwg 29/06/21 1:45:56 revms

SCALE 1:500 A1