

**Plan Information**

Tenure Type	Freehold
Plan Type	Deposited Plan
Plan Purpose	Subdivision

**Plan Heading**

LOTS 532-560, 8033, ROADS, RESTRICTIVE COVENANT AND COVENANTS

**Locality & Local Government**

Locality	DAYTON
Local Government	CITY OF SWAN

**Department of Planning, Lands and Heritage**

File Number	
-------------	--

**Examination**

Examined	Date
----------	------

**Planning Approval**

Planning Authority	Western Australian Planning Commission
Reference	160391

Delegated under S. 16 P&D Act 2005	Date
------------------------------------	------

**In Order For Dealings**

Subject To	SURRENDER OF EASEMENT A - DOC O361019, EASEMENT B - DOC O361018 AND EASEMENT G - DOC B779544
------------	--

For Registrar of Titles	Date
-------------------------	------

**Plan Approved** Reg. 26A (1),(4)

Inspector of Plans and Surveys / Authorised Land Officer	Date
--	------

**Survey Details**

Field Records	156141
Declared as Special Survey Area	Yes

**Survey Method Regulatory Statement**

Survey carried out under Reg. 26A Special Survey Area Guidelines. See survey sheet(s) to determine the true final position and type of all survey marks placed for this plan.

**Survey Method and Plan Content Variations**

<b>Approved Variation Type</b>	<b>Reference</b>
REG 26A(1) FINAL MARKING DEFERRED	(Approved ID DXXX-XX - Dated XX Month Year, Landgate File 0XXXX-20XX)

**Survey Certificate - Regulation 54**

I, Matthew B. WEBB hereby certify that this plan is accurate and is a correct representation of the -  
 (a) survey; and  
 (b) calculations from measurements recorded in the field records, undertaken for the purposes of this plan and that it complies with the relevant written law(s) in relation to which it is lodged.

Licensed Surveyor	Date
-------------------	------

**Survey Organisation**

Name	MNG MCMULLEN NOLAN GROUP
Address	PO Box 3526, SUCCESS W.A. 6964
Phone	6436 1599
Fax	6436 1500
Email	info@mngsurvey.com.au
Reference	93980dp-572c

**Amendments**

Version	Lodgement Type	Amendment Description	Authorised By	Date
---------	----------------	-----------------------	---------------	------

**Former Tenure**

New Lot / Land	Parent Plan Number	Parent Lot Number	Title Reference	Subject Land Description
532-560, 8033	DP 405739	2	2909-895	

**Former Tenure Interests and Notifications**

Subject	Purpose	Statutory Reference	Origin	Land Burdened	Benefit To	Comments
	MINERAL RESERVATION		DOC T32138/1967	LOTS 532-534, 541-546, 558-560 AND PORTION MARKED (M)		

**New Interests**

Subject	Purpose	Statutory Reference	Origin	Land Burdened	Benefit To	Comments
(B) < (C)	RESTRICTIVE COVENANT	SEC 136D OF THE TLA	THIS PLAN & DOC	ALL LOTS EXCEPT LOT 8033	ALL LOTS EXCEPT LOT 8033	RESTRICTION OF ACCESS NO ROAD VEHICLE ACCESS TO AND FROM HARROW STREET
(D) < (E)	COVENANT	SEC 150 OF THE P & D ACT	THIS PLAN	LOTS 558 AND 559	CITY OF SWAN	RESTRICTION OF ACCESS NO ROAD VEHICLE ACCESS TO AND FROM HARROW STREET
	COVENANT	SEC 150 OF THE P & D ACT	THIS PLAN	LOT 560	CITY OF SWAN	RESTRICTION OF ACCESS NO ROAD VEHICLE ACCESS TO AND FROM HARROW STREET

**New Notifications and Memorials**

Subject	Purpose	Statutory Reference	Origin	Land Burdened	Benefit To	Comments
	NOTIFICATION	SEC 165 OF THE P & D ACT	DOC	LOTS 532-535, 540-548, 552-557 AND 558-560		BUSHFIRE MANAGEMENT PLAN

**Vesting Lots**

Subject	Purpose	Statutory Reference	Origin	Land Burdened	Benefit To	Comments
LOT 8033	RESERVE FOR DRAINAGE	VESTS IN THE CROWN UNDER SEC 152 OF THE P & D ACT	THIS PLAN			

**AMENDMENTS TABLE**

Revision	Description	Date
A	Initial Issue	4/8/2021
B	Amendments after PM audit	9/8/2021
C	Add Lots 556 & 557 into 165 Notification for BFM	10/8/2021

**DRAFT**  
 ALL AREAS AND DIMENSIONS ARE SUBJECT TO FINAL SURVEY AND WAPC APPROVAL

PRELIMINARY ONLY  
 UNLODGED VERSION  
 SUBJECT TO  
 LANDGATE AUDIT

This version is  
 - Current as at 9/08/2021  
 - Subject to change without notice  
 - Not intended for design use,  
 a LANDGATE APPROVED copy should be obtained for such purposes.

UNLODGED VERSION



MCMULLEN NOLAN GROUP  
 PO Box 3526, Success W.A. 6964  
 Tel: (08) 6436 1599  
 Fax: (08) 6436 1500  
 Email: info@mngsurvey.com.au

MNG Ref : 93980dp-572c - Stage 1Y - DP422265.CSD

ADDITIONAL SHEETS  
 SURVEY SHEET

SHEET SHEETS  
 1 OF 2

VERSION NUMBER  
 1

DEPOSITED PLAN  
 422265

UNLODGED VERSION

# UNLODGED VERSION

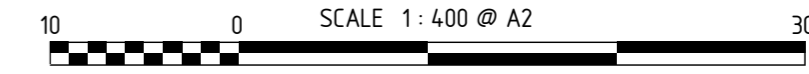

ALL DISTANCES ARE IN METRES

LIMITED IN DEPTH TO 12.19 METRES  
AS TO LOC 8283 ONLY  
LIMITED IN DEPTH TO 60.96 METRES  
AS TO LOTS 532-534, 541-546,  
558-560 AND TO PORTION  
MARKED (M) ONLY

**DRAFT**  
ALL AREAS AND DIMENSIONS  
ARE SUBJECT TO FINAL SURVEY  
AND WAPC APPROVAL

**PRELIMINARY ONLY  
UNLODGED VERSION  
SUBJECT TO  
LANDGATE AUDIT**  
This version is  
- Current as at 10/08/2021  
- Subject to change without notice  
- Not intended for design use,  
a LANDGATE APPROVED copy  
should be obtained for such purposes.

UNLODGED VERSION

UNLODGED VERSION

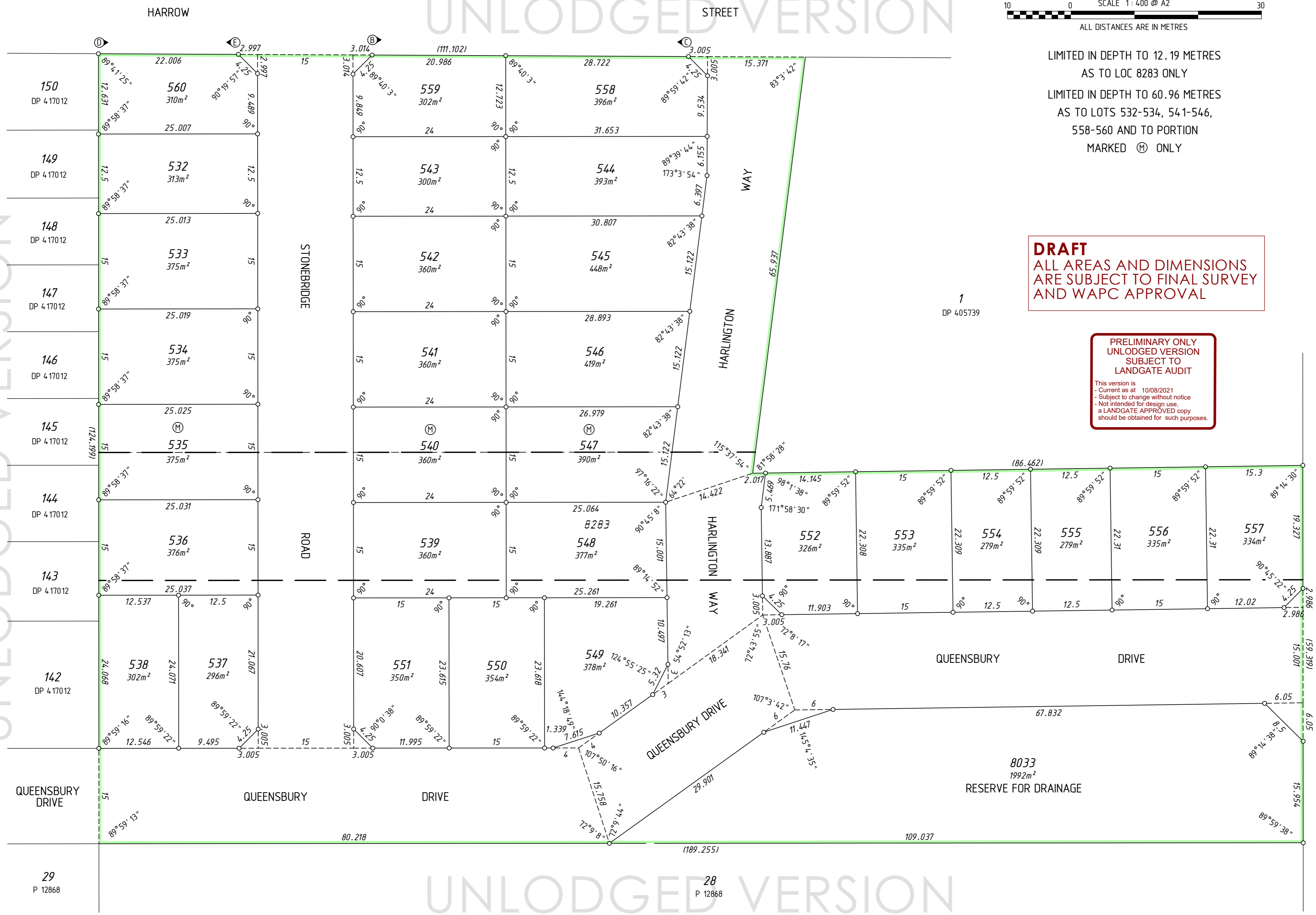

**DRAFT**  
ALL AREAS AND DIMENSIONS  
ARE SUBJECT TO FINAL SURVEY  
AND WAPC APPROVAL

UNLODGED VERSION

PRELIMINARY ONLY  
UNLODGED VERSION  
SUBJECT TO  
LANDGATE AUDIT

This version is  
- Current as at 10/08/2021  
- Subject to change without notice  
- Not intended for design use,  
a LANDGATE APPROVED copy  
should be obtained for such purposes.

UNLODGED VERSION

UNLODGED VERSION

THIS SURVEY SHEET WILL BE  
REPLACED BY THE SURVEY DATA

UNLODGED VERSION



MC MULLEN NOLAN GROUP  
PO Box 3526, Success W.A. 6964  
Tel: (08) 6436 1599  
Fax: (08) 6436 1500  
Email: info@mngsurvey.com.au

MNG Ref : 93980dp-572c

VERSION NUMBER

1

DEPOSITED PLAN  
**422265**